

W

THE PAINTER PARTITION PLAT.

PLAT of the SUBDIVISION for the purpose of SALE under decree for PARTITION among heirs of JOHN PAINTER, decd, rendered by the Circuit Court of Cape Girardeau County, Missouri, of LOTS 65, 66, 67, 68, 69, 70, 71 & 72 RANGE G, LOTS 55, 56, 57, 58, 59, 60, 61, 62, 63 & 64 RANGE A, LOTS 41, 42, 43, 44, 45, 46, 47 & 48 RANGE B.

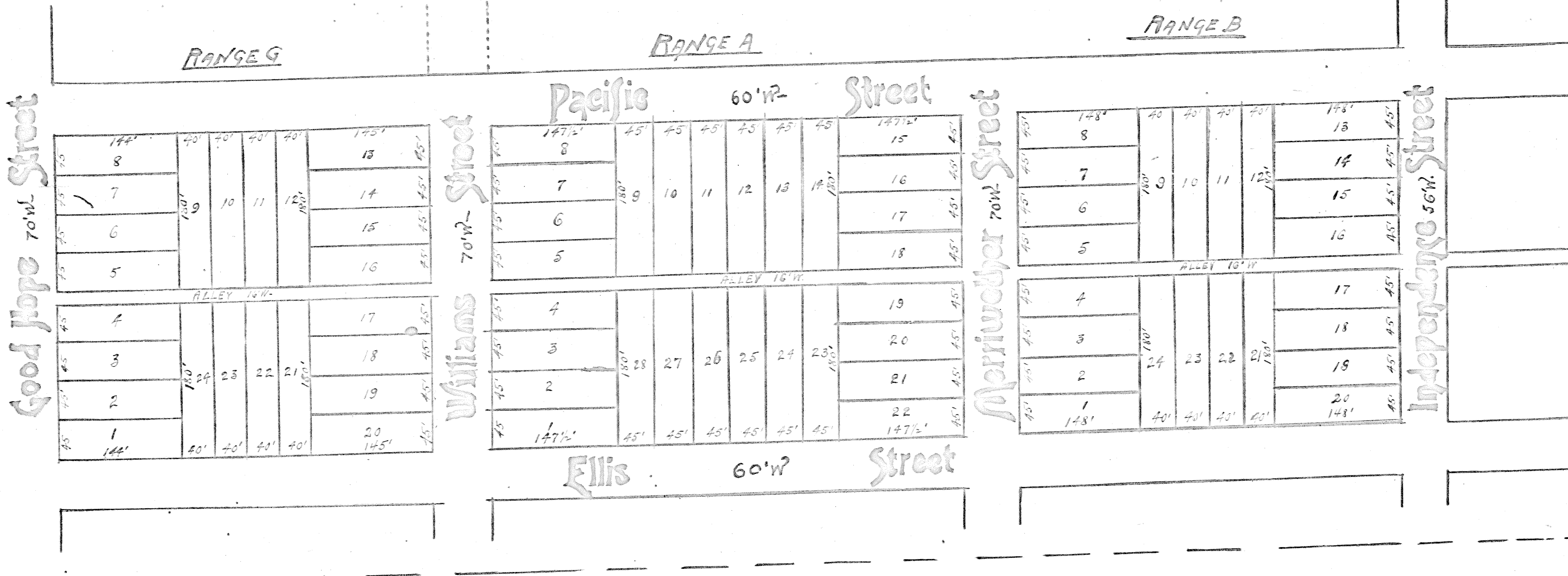

Good Hope 70'W Street

Williams 70'W Street

Merriweather 70'W Street

Independence 50'W Street

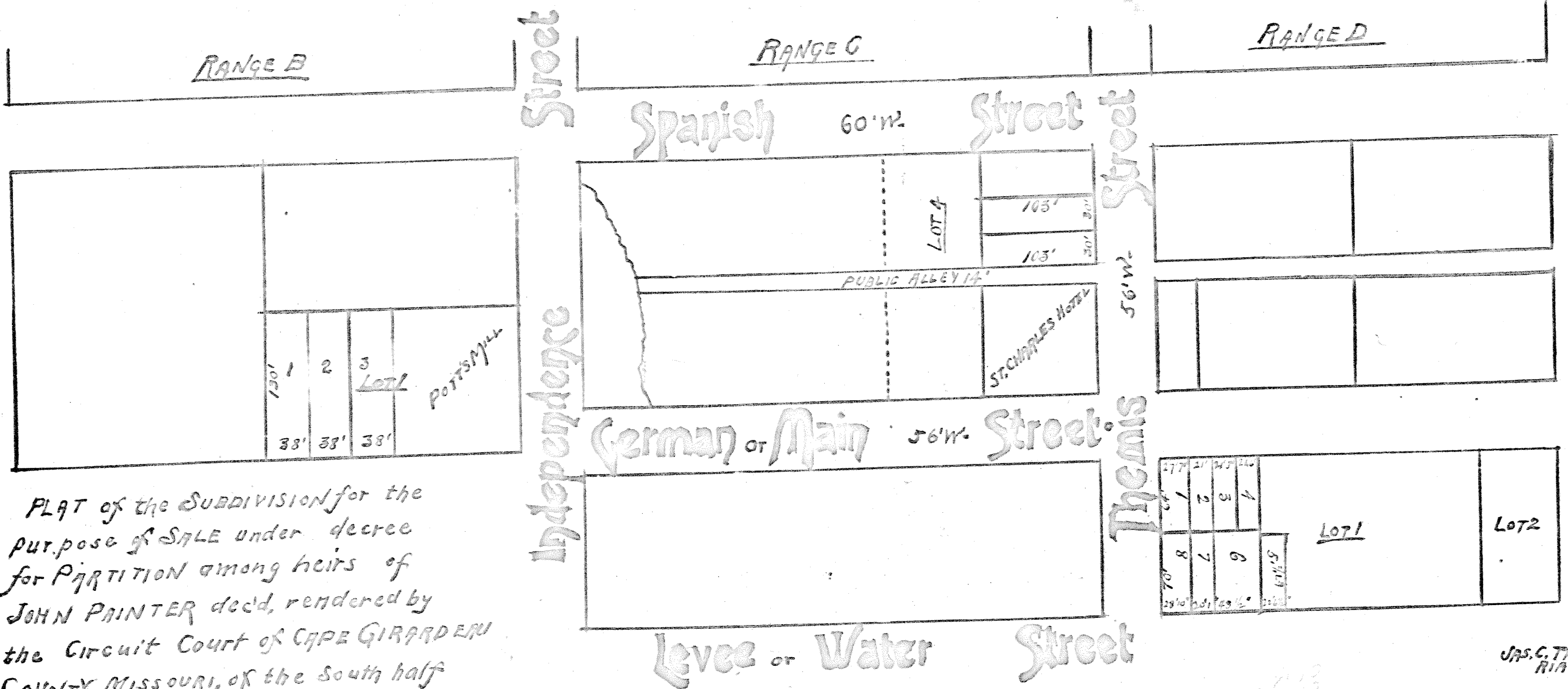

Filed Aug. 20
Christ & Better
Clerk & Recorder

PLAT of the SUBDIVISION for the purpose of SALE under decree for PARTITION among heirs of JOHN PAINTER decd, rendered by the Circuit Court of Cape Girardeau County, Missouri, of the South half LOT 1 RANGE B, part of LOT 4 RANGE C, and part of LOT 1 RANGE D

JAS. C. TRAVILLA
PLAT 75 BLO 9 ST. LOUIS MO

I, the undersigned, J. M. Raudol, Sheriff of Cape Girardeau County, Mo, hereby certify that the foregoing are correct plats of the subdivision made by me for the purpose of sale of that part of the real estate ordered to be sold to make partition among the heirs of John Painter, decd, which was deemed advisable and for the best interest of all concerned to subdivide.

J. M. Raudol Sheriff.